

THIS DRAWING AND THE DATA DISCLOSED HEREIN OR HEREWITH IS NOT TO BE REPRODUCED USED OR DISCLOSED IN WHOLE OR IN PART TO ANYONE WITHOUT THE PERMISSION OF JESS-LINK PRODUCTS CO.,LTD.(JPC)

CUSTOMER DRAWING

DRWC-002397

REV.	ECN NO.	DESCRIPTION	MDF'D	APP'D	DATE
A1	---	First Edition	Kevin	Pefer	08/04/2021
A3	---	Bare Copper Copper changed to Tinned Copper	Kevin	Pefer	2/09/2022
A4	---	Add Spec.	Chunxia	Richard	04/19/2024

NUMBER OF CORES	WIDTH (mm)	TP(mm)	ALLOWABLE ERROR(mm)	P/N:
2	1.2	-	±0.10	
3	1.8	-	±0.10	PHAF32EBC032-1
9	5.4	4.8	±0.15	PHAF32EBC092-1
12	7.2	6.6	±0.15	PHAF32EBC122-1



$$S(\text{Eccentricity}) = |a-b|/2 < 0.05$$

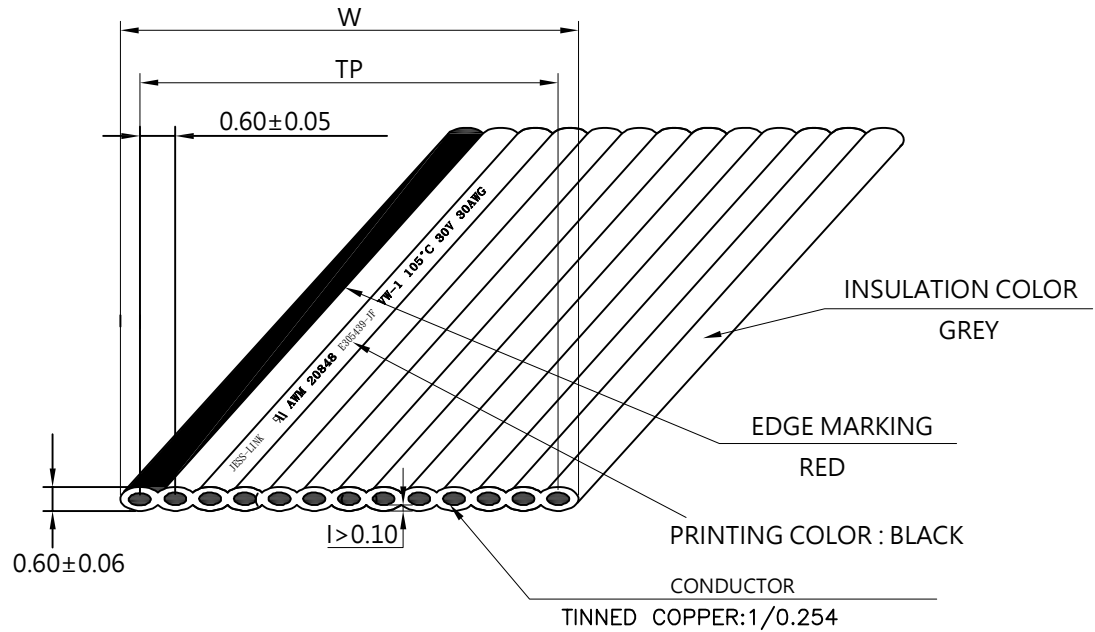
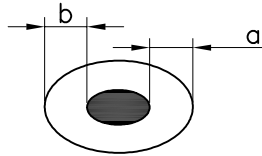

PRINTING:

JESS-LINK ㉑ AWM 20848 E305439-JF VW-1 105°C 30V 30AWG

ITEM	SUPL	SUPL PN	DESCRIPTION	Q'TY
1				
2				
3				
4				
5				

RoHS COMPLIANT

HALOGEN FREE

Unit : mm
 GENERAL TOLERANCES:
 (UNLESS SPECIFIED)
 0 = ±1(0.039)
 0.0 = ±.5(0.02)
 0.00 = ±.3(0.012)
 0.000 = ±.15(0.006)
 0° = ± 2°
 0.0° = ± 1'

PROJECTION

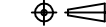

D.R. 04/19/2024 Chunxia
 CH.K 04/19/2024 Andrew
 APV.D 04/19/2024 Richard

TITLE			PD./FILE NO.
HAF4 SERIES 30AWG P=0.6			XXXXXXXXXX
SCALE	SIZE	PART NO.	REV. A4
NA	A4	PHAF32EBC122-1	SHEET 1 OF 2

JPC connectivity

